

PRESS RELEASE

ARCHI & BD La VILLE Dessinée (ARCHITECTURE & COMICS - THE CITY, ILLUSTRATED)

**EXHIBITION PRESENTED AT THE CITÉ DE L'ARCHITECTURE &
DU PATRIMOINE FROM 9 JUNE TO 28 NOVEMBER 2010**

LAUNCH ON 8 JUNE 2010 FROM 7PM

PRESS CONFERENCE FROM 5PM

The "Archi & BD" (architecture and comics) exhibition will be held at the Cité de l'Architecture & du Patrimoine from 9 June until 28 November 2010, covering 1000 square metres in the upper gallery for temporary exhibitions. It will present the relationships between comics and architecture to the general public and comic book enthusiasts.

A GENERAL INTRODUCTION

From the beginning of the 20th century, with authors like Winsor McCay (Little Nemo), George McManus (Bringing Up Father), Frank O. King (Gasoline Alley) and Alain Saint-Ogan (Zig et Puce), comics have explored the city, fascinated by the emerging world that they represent.

This theme does not only cover the city itself, but also the elements directly related to it including architecture, urban development, design, history and politics. It became an ideal format for aesthetic descriptions and reflections on the modern world with authors such as François Schuiten, Benoît Peeters, Enki Bilal, and Moebius...

Curator Contact

Lucile Rives
06 18 62 61 03
lucile.rives@gmail.com

Press Contacts

Cité
Agostina Pinon
01 58 51 52 85
06 03 59 55 26
apinon@citechailot.fr

Opus64

Valérie Samuel
and Arnaud Pain
01 40 26 77 94
a.pain@opus64.com



Daredevil
© Galerie 9ème art, Paris

The exhibition will portray representations of the city in comics and does not aim to be exhaustive.

Works will be arranged chronologically from the 1900s to the present day, with special projects presented at the end of the exhibition: the imaginary city of Villemolle by Requins Marteaux, the Hergé museum, the Maison de Verre, an order from Jean Nouvel to comic book authors.



This chronological display includes references to different cities. New-York, Paris and Tokyo will be observed through the prism of authors like Will Eisner, Jack Kirby, David Mazzuchelli and Riad Sattouf for New York; Blutch, Tardi and Dupuy-Berberian for Paris; Jiro Taniguchi, Osamu Tezuka, Toiyo Matsumoto and Maoki Urasawa for Tokyo. This international dimension will be supported by the presence of Chinese and Korean authors.

1. © Marc-Antoine Mathieu
2. © Dupuy-Berberian – Dupuis 2003
3. © Jacques de Loustal

The exhibition will also investigate the close relationship and affinities between authors of different generations, like the ligne claire of the end of the 1970s (Joost Swarte, Ted Benoit, Floc’h...) which draws inspiration from the Belgian comic book masters of the 1950s and 1960s: André Franquin, Maurice Tilleux, Will...

A DIVERSE ARRAY OF WORKS AND CREATORS WITH ORIGINAL SCENOGRAPHY

The “Archi & BD” exhibition will portray a vision of the artistic and cultural depth of comics to the general public through a century of creation. The scenography is designed by Projectiles and makes original use of light and space to highlight the presented works.

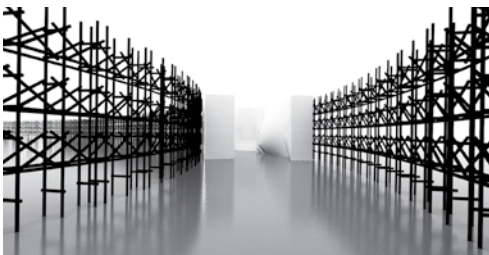

This exhibition includes a total of 150 international authors and 350 works and aims to show how modern comics are pushing the boundaries of creativity, with comic authors closely linked to contemporary art such as Jochen Gerner, Ilan Manouach, Dominique Goblet, Thierry Van Hasselt, and Christopher Hittinger.

There will also be a special area for young visitors.

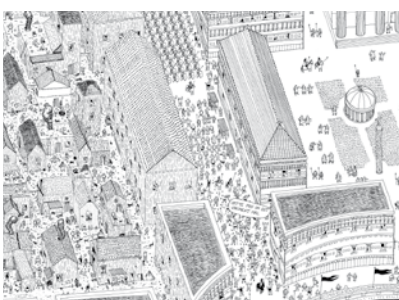

© The Hoochie Coochie / Christopher Hittinger / 2009

ARCHITECTURAL REPRESENTATIONS AND URBAN FICTION

This exhibition is a dialogue between architecture and comics.

Models, sketches, town plans and creations, public buildings and villas, utopias drawn by the greatest architects reminding us of the familiarity of these imagined realities.

In contrast to the plates of the comic authors where the city is heroine, architectural works reveal how they in turn have been influenced by the 9th art... This section of the exhibition focuses on the way architecture and the city are represented and attempts to explore the closely linked illustrated worlds from the 1910s (Sant'Elia) to the present day (BIG, Herzog & De Meuron and André Jaque...), not forgetting the 1970s (Archigram, Coop Himmelblau and Jean Balladur...).

The many visions of the city reveal a tendency to imagine the future and a desire to explore new ways of life. To London, Vienna, Madrid or Paris; it is an invitation to journey through urban fiction and the most fantastical metropolitan scripts.

In order for the marriage between architecture and comics to be a success, the Cité de l'Architecture has decided on a joint-curatorship between Jean-Marc Thévenet, director of the Angoulême International Comics Festival from 1998 to 2006, and Francis Rambert, director of the Institut Français d'Architecture.

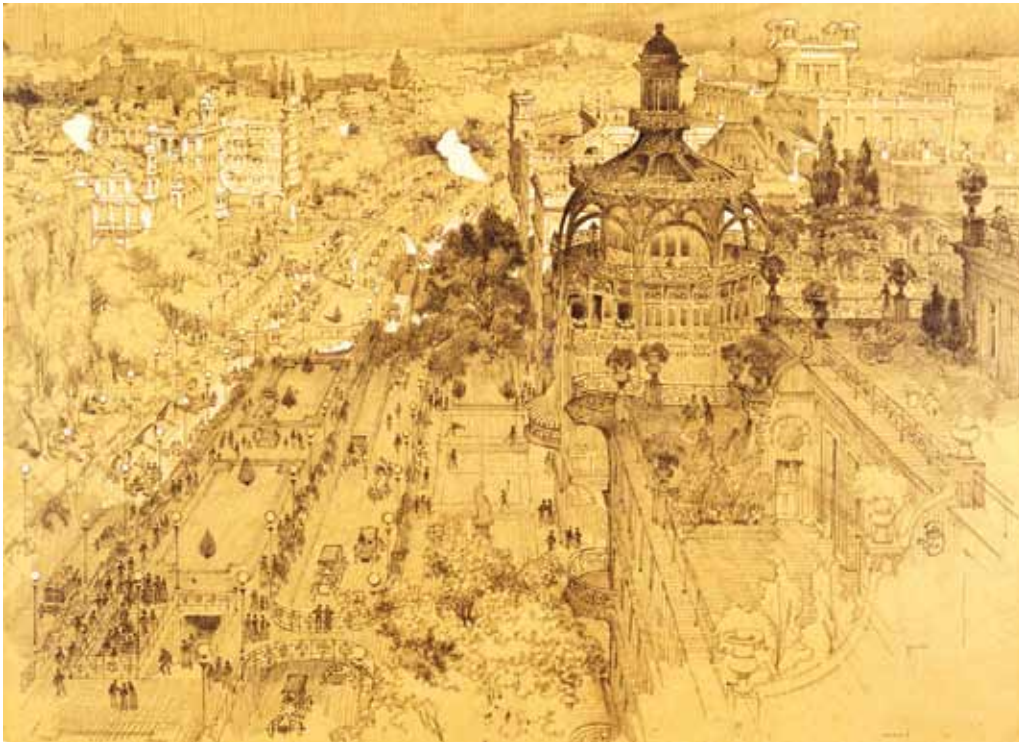

Drawing, Louis Bonnier
© IFA / Centre d'archives
d'architecture du XX^e siècle
(centre for 20th Century
architectural archives)

Exhibition designed and created by the Cité de l'Architecture & du Patrimoine / Institut Français d'Architecture

Curated by: Jean-Marc Thévenet and Francis Rambert

Scenography: Projectiles

**CITÉ DE L'ARCHITECTURE & DU PATRIMOINE – PALAIS DE CHAILLOT
1 PLACE DU TROCADÉRO – PARIS 16th (METRO STOP: IÉNA OR TROCADÉRO)**

**OPEN EVERY DAY FROM 11AM TO 7PM EXCEPT TUESDAYS – OPEN THURSDAY
EVENINGS UNTIL 9PM – TICKETED ENTRY: FULL PRICE – 8 EUROS /
CONCESSIONS – 5 EUROS / FREE FOR UNDER 12s**

ALONGSIDE THE EXHIBITION

CATALOGUE

Archi & BD. La ville dessinée (Architecture & comics. The city, illustrated)

Cité de l'Architecture & du Patrimoine and Monografik - 256 pages, 250 illustrations – retail price: 39 €

EVENTS FOR YOUNG VISITORS

Paris-Tokyo. villes en morceaux (Paris-Tokyo, cities in pieces)

Exhibition-workshop for 6-12 year olds

9 June to 28 November 2010 (except 28 June to 9 July 2010)

Special opening hours: 2pm to 6pm, everyday (except Tuesdays)

Museum / Gallery of Casts - Viollet-le-Duc room

Alongside "Archi & BD", this exhibition-workshop allows visitors to create their own town plans, inspired by those of Armelle Caron. Another young author of comics, Florent Chavouet, presents her personal vision of Tokyo, through drawings she sketched on walks around the city.

Exhibition presented by the Cité de l'Architecture & du Patrimoine / Public Information

Free entry for children accompanied by an adult with a ticket for the museum

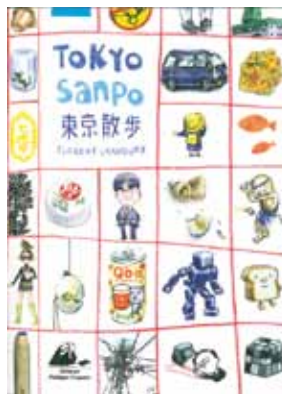

1. Plan de Paris © Armelle Caron
2. Book cover "Tokyo Sanpo"
© Florent Chavouet

"Paris-Tokyo. villes en morceaux" (cities in pieces) workshop

9 June to 28 November 2010 (except 28 June to 31 August 2010)

Every Wednesday, Saturday and Sunday at 3.30pm

Duration: 1 hour 30 mins / price: 8 €

Sans réservation, achat des billets aux caisses du hall principal pour le jour même, ou en avance pour une date fixe, dans la limite des places disponibles.

GUIDED TOURS OF THE EXHIBITION

Wednesdays at 3.30pm, from 16 June to 28 November

This guided tour talks about the dialogue between the city, architecture and comics. It is an opportunity to highlight the many links between these respective creations from the invention of the comic to the present day, particularly through three large cities: New York, Paris, and Tokyo.

Tickets can be purchased from tills in the main hall for the same day or a fixed date in the future.

This tour can be booked for groups at other dates and times. Also available in other languages (English, German, Spanish, Italian, others) – please see the website for more information: www.citechailot.fr

AUDIO-VISUAL PROGRAMME

A programme of architectural sequences specially designed for the exhibition that mixes feature-length fiction, documentaries and animated films will be shown to the public in the auditorium at the Cité de l'Architecture from October 2010.

The programme has not yet been finalised and will be available soon at www.citechailot.fr

TO FIND OUT MORE – WWW.CITECHAILLOT.FR AND FROM THE END OF APRIL 2010 THERE WILL BE A SPECIAL SITE DEDICATED TO THE EXHIBITION: WWW.ARCHIETBD.CITECHAILLOT.FR WITH INTERVIEWS WITH THE AUTHORS, INFORMATION PREVIEWS AND UNSEEN PLATES...